

## PRODUCT OVERVIEW

CNC machine tools in the process of automatic machining, due to high cutting intensity, high temperature, residual cutting, tool aging and other factors, may lead to tool wear or breakage, if you can not find the damage of the tool in time, it will cause major production and even safety accidents. This product can effectively detect the wear or breakage of the tool, and the whole inspection process is executed in the tool magazine, without taking up the processing time. It can be used for the detection of tools in disk-type tool magazine and chain-type tool magazine.

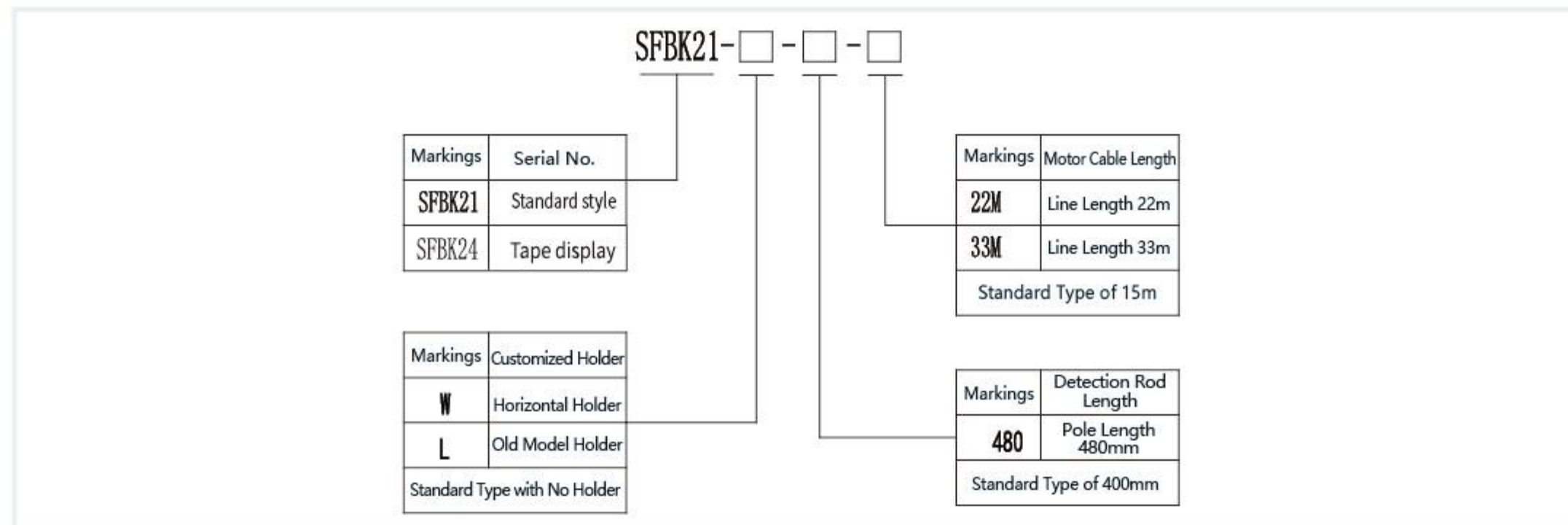

## MODEL DESCRIPTION



## OVERALL INSTALLATION DIMENSION DRAWING

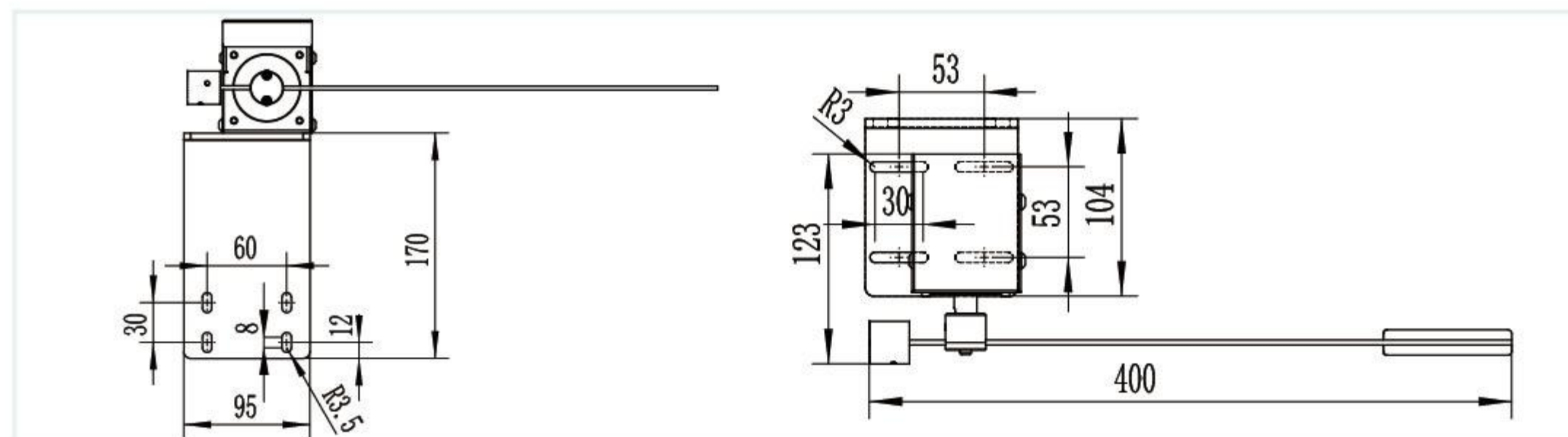

## OVERALL EFFECT DIAGRAM

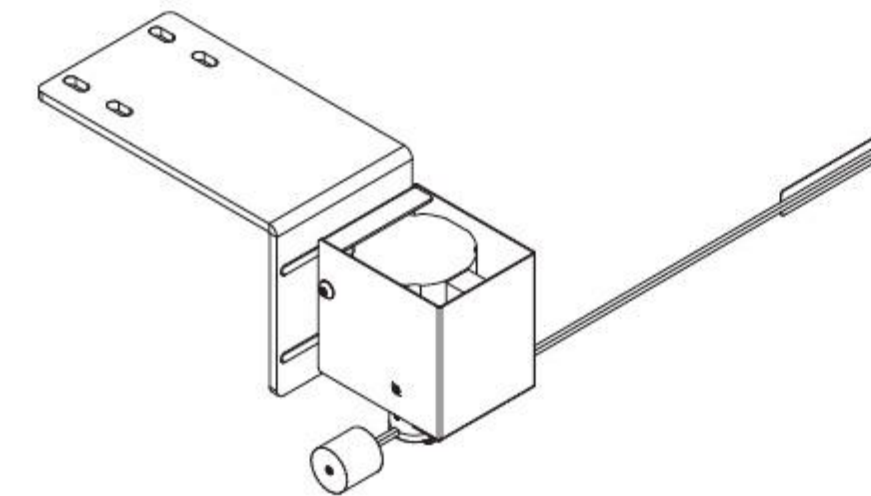

## MACHINE INTERFACE SCHEMATIC

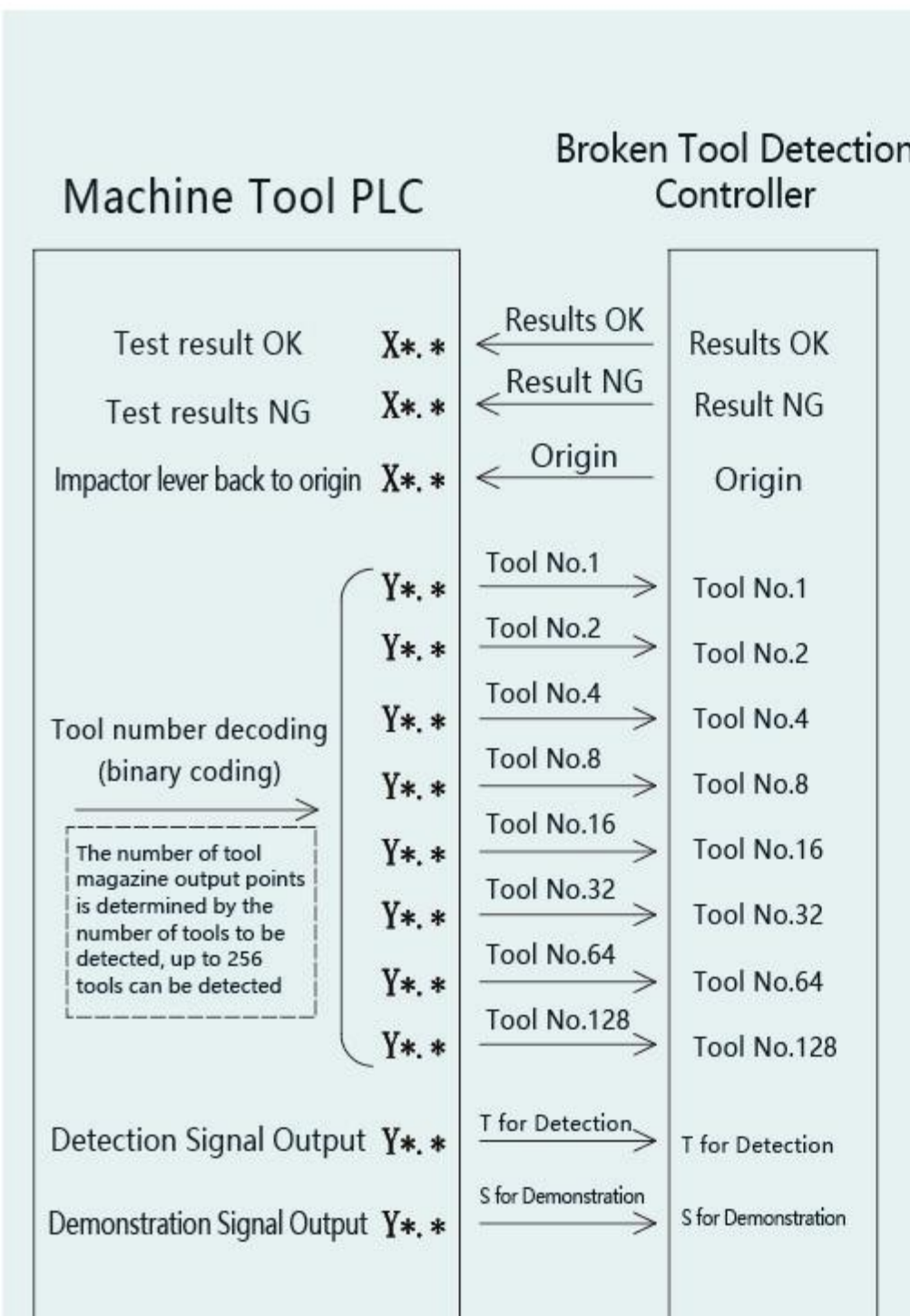

## MAIN TECHNICAL PARAMETERS

Serial Number	Item	Standard
1	Rated Power	220W
2	Controller Power Supply	24V DC±10%
3	Driver Power Supply	220V AC
4	Input & Output Levels	24V effective
5	Ambient Temperature for Operation	-10°C~+60°C
6	Protection Level	Detection device IP67
7	Detection Rod Length	400mm
8	Detection Angle	5°~150°
9	Working life	10 million times
10	Single Detection Time	0.3-2 sec
11	Detection Accuracy	Adjustable up to 1mm
12	Trigger force	Adjustable
13	Direction of rotation	Adjustable
14	Tool No. & alarm code	viewable
15	Zero-back mode	Manual/automatic
16	Pre-positioning	have
17	Display interface	Function selection
18	Mounting Holder	Adjustable Position
19	Net product weight	5.2kg

## DETECTION/DEMONSTRATION TIMING CHART

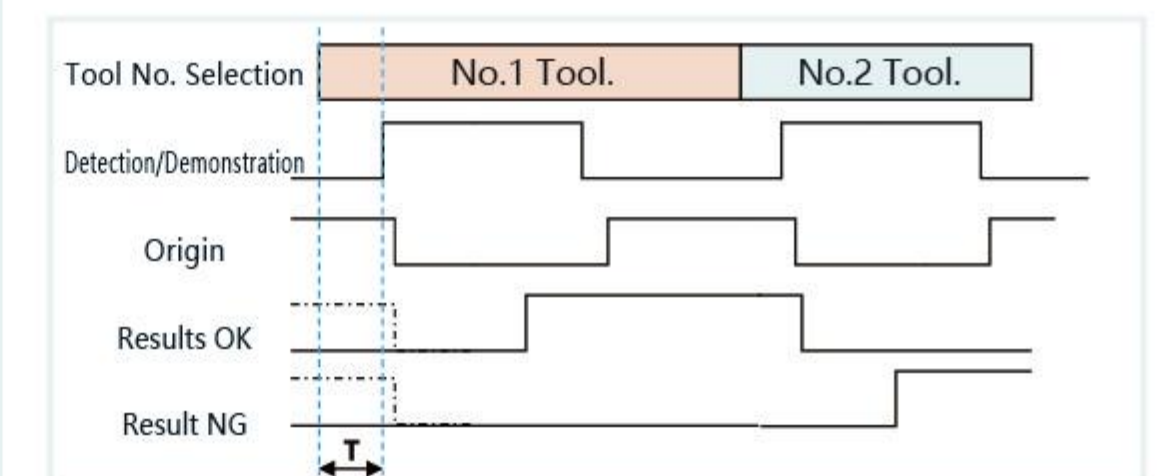

## DEMONSTRATION INSTRUCTIONS

Detect No. 1 tool, output result OK, detect No. 2 tool, output result NG.

The demonstration/detection signal needs to lag the tool number selection signal by at least time T50ms.

The output of the demonstration/detection signal needs to be greater than 50ms.

The CNC can check the status of OK or NG after the home position is in place.